

HAND CUT BLOCK UNITS  
TO WITHIN  $\frac{1}{2}$ " OF PIPE

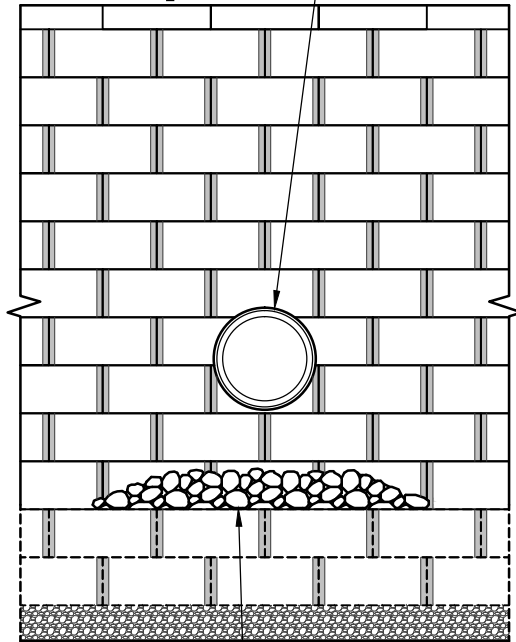

SCOUR PROTECTION AS REQUIRED.  
USE RIPRAP OR PRECAST SLAB IN  
OUTLET AREA (DESIGNED BY OTHERS)

FACE VIEW

CAP BLOCK

TOP COURSE PLACED  
UP-SIDE-DOWN TO  
ALLOW FOR CAP BLOCK

GEOHOLD PRO  
BLOCK

1.7°

SCOUR  
PROTECTION

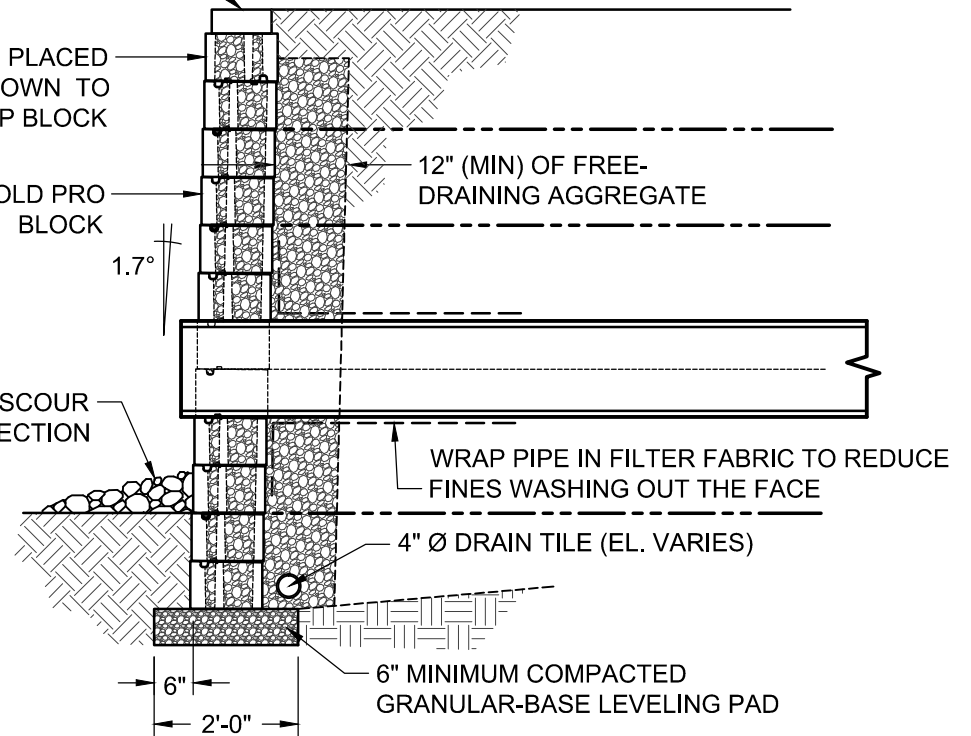

12" (MIN) OF FREE-  
DRAINING AGGREGATE

WRAP PIPE IN FILTER FABRIC TO REDUCE  
FINES WASHING OUT THE FACE

4" Ø DRAIN TILE (EL. VARIES)

6" MINIMUM COMPACTED  
GRANULAR-BASE LEVELING PAD

6"

2'-0"

SECTION VIEW



This drawing is for illustrative purposes only and should not be used for construction without the signature of a registered professional engineer.

www.anchordiamond.com

© 2023 ANCHOR Engineering, LLC®  
and © 2023 ANCHOR DIAMOND Group. All rights reserved

## GeoHold Pro Retaining Wall System

### Typical Details for Small Utilities Through Wall

Scale:	None	Drawn by:	DA
Date:	9/28/2023	Drawing number:	GHP21