

CUT CAPS AS NECESSARY
FOR CURVED WALLS

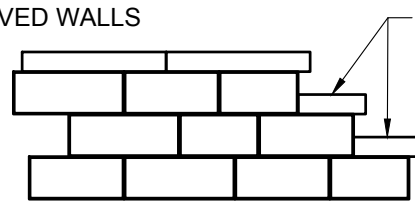

TOP



CUT CAPS TO
FIT AS NEEDED

WALL FACE

1. ALWAYS START CAPPING WALL FROM THE LOWEST ELEVATION.
2. LAYOUT CAPS PRIOR TO USING ADHESIVE.
3. CUT CAPS TO FIT AS NECESSARY.
4. USE EXTERIOR-GRADE CONSTRUCTION ADHESIVE TO SECURE CAPS.



BELGARD

belgard.com

877-235-4273

details@belgard.com

This drawing is for illustrative purposes only and should not be used for construction without the signature of a registered professional engineer.

Tandem® Retaining Wall System

Capping Details

Scale:

3/8" = 1'-0"

Date:

4/1/2016

Drawn by:

SB

Drawing number:

TDRE02